

FCS KA30 Large Peristaltic Pump



Roller Components

Product Features

3.2" LCD screen displays both flow rate and motor speed. Keypad and digital knob control for easy operation. Various external control interfaces support RS232/RS485 communication.

- ✓ Long Service Life: The planetary gear rollers are powered by self-transmission, rolling friction with the tube, extending its service life
- ✓ High Torque, Shock Resistant: Multi-surfaced planetary gears receive shock loads evenly across 360°, reducing the load on each gear and allowing higher torque
- ✓ Runs Smoothly: Multi-point uniform fit on gears achieves higher precision positioning

Dimension Drawing (units: mm)

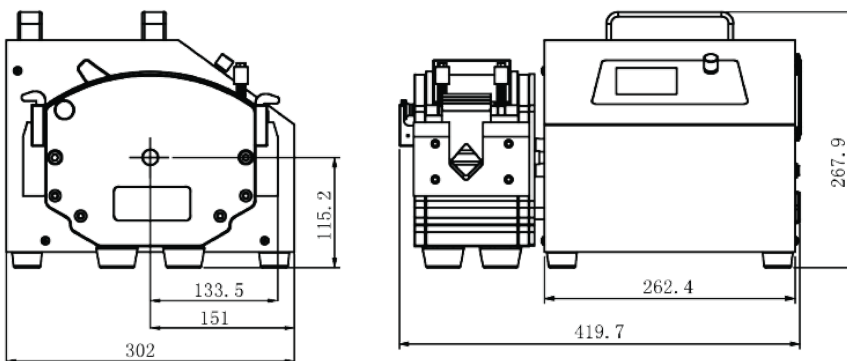

Tubing With Connector



Continuous Tubing

Product Composition & Flow Rate Range

Motor Type	Tubing Size	Speed Range (rpm)	Flow Rate (L/h)
Closed-loop stepper motor	88#, 92#	0.1~300	0.6-1800

Technical Specifications

Flow rate range	0.6~1800 L/h
Speed range	0.1-300 rpm
Flow rate accuracy	<± 0.5%
Speed resolution	0.1 rpm
Fixed time dispensing function	0.1s~9999h
Back suction angle	0-360°
Control method	Mechanical keypad + digital knob
Display	3.2" Hi-Def LCD Screen
Start/stop, direction signal	Passive switch signal (foot pedal), Active switch signal: 5V, 12V and 24V options
External speed control signal	0-5V, 0-10V, 4-20mA
Output interface	Output motor working status (open-collector output)
Power supply	AC 220V±10%, 50Hz/60Hz (standard); AC 110V±10%, 50Hz/60Hz (optional)
Power	< 300W
Communication interface	RS232, RS485 Modbus protocol (RTU mode)
Drive dimension	262.4L x 302W x 267.9H mm
Drive weight	13.5 kg
Condition temp	0-40°C
Relative humidity	< 80%

